



SHUANG XING TOYS

# Use instruction

■ Thank you for choosing our toy R/C car. To ensure correct and pleasing operations, please read through the following use instruction and have enough understanding of the product before use.

## ⚠ CAUTION:

### ■ ELECTRICALLY OPERATED PRODUCT

Not recommended for children under 6 years of age. As with all electric products, precautions should be observed during handling and use to prevent electric shock.

### How to recharge the Battery pack?

1. If 1.5V AA non-rechargeable batteries are used, simply load in the batteries according to the polarity marks.
2. If rechargeable battery is used, please plug in the charger and insert the plug of the battery into the charging jack on the charger. (Picture 1)
3. Allow battery pack to be charged for a minimum of 8 hours for the first and second charges, subsequent charges require 5-6 hours. Do not over charge the Battery pack. Charging the battery pack for a longer period will not increase the Battery charge life.
4. Battery charger used with the toy are to be regularly examined, For damage to the cord, plug, enclosure and other parts, and that, in the event of such damage, the toy must not be used with this charger until the damage has been repaired.

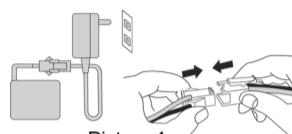

Picture 1

### Transmitter and Vehicle operation

#### Operations Tips:

1. Please make sure the power switch is in the ON position when you operate, and OFF position when not in use.
2. If the car direction goes left, please adjust Steering alignment Lever to right until the car goes straight.
3. If the car direction goes right, please adjust Steering alignment Lever to left until the car goes straight.

Steering alignment Lever

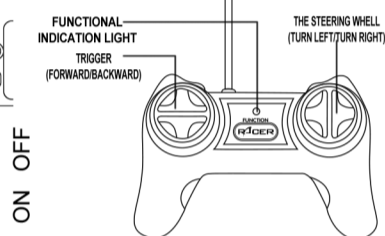
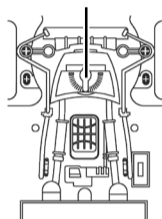

### Battery and Antenna Installation-Transmitter and Vehicle

1. Install one Two AA1.5V Battery with polarity(+/-) as shown inside batter compartment. (Picture 1)
2. Follow the arrowhead to close the remote control's battery cover.
3. Install new batteries or fully charged rechargeable batteries into the battery compartment on the chassis.
4. Tighten battery door with a Philips head screwdriver.

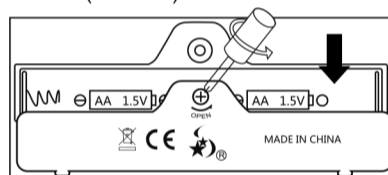

Picture 1

### How to play?

1. Install the rechargeable battery inside the battery compartment that is underneath the chassis, taking care to observe the polarity. Fit back the cover.
2. Insert Two AA1.5V Battery inside the controller. The car is now ready to run.
3. Turn the two switches located on both the car and the controller to the "ON" position and then operate the car.
4. If the car does not run in a straight line adjust the steering alignment lever located beneath the chassis.
5. When the light in the controller begins to dim, it may be time to replace the 9V battery.
6. When your R/C model car begins to lose performance, power or function, it may be time to recharge the rechargeable battery!

### Battery safety Information

1. Don't short-circuit terminals.
2. Don't recharge non-rechargeable batteries.
3. Rechargeable batteries may only be charged under the supervision of an adult.
4. Remove all batteries if vehicle will not be used for a long period of time.
5. Dispose of batteries safely. Don't dispose of batteries in fire as they may explode.
6. The battery charger used should be regularly examined for damage to the cord, plug, enclosure and other parts. In the event of damage do not use it until it has been repaired.
7. Exhausted batteries are to be removed from the toy.
8. Keep these instructions for future reference: they contain important information.
9. Packaging has to be kept since it contains important information.
10. Rechargeable batteries are to be removed from the toy before being charged.

### Care and Maintenance

1. Always remove batteries from the toy when it is not being used for a long period of time.
2. Wipe the toy gently with a clean damp cloth.
3. Keep the toy away from direct sunlight and/or direct heat.
4. Do not submerge the toy into water that can damage the electronic assemblies.

SHANTOU SHUANGXING TOYS CO.,LTD

Address: Yangdongpian industrial Area, Dongwan, Lianxia, Chenghai, Shantou.

Tel : 0754-85160487 85173487 Fax: 0754-85169487

E-mail: chshuangxing@163.com

QQ:792414861 1584542751



Open a Web page by phone scanning